

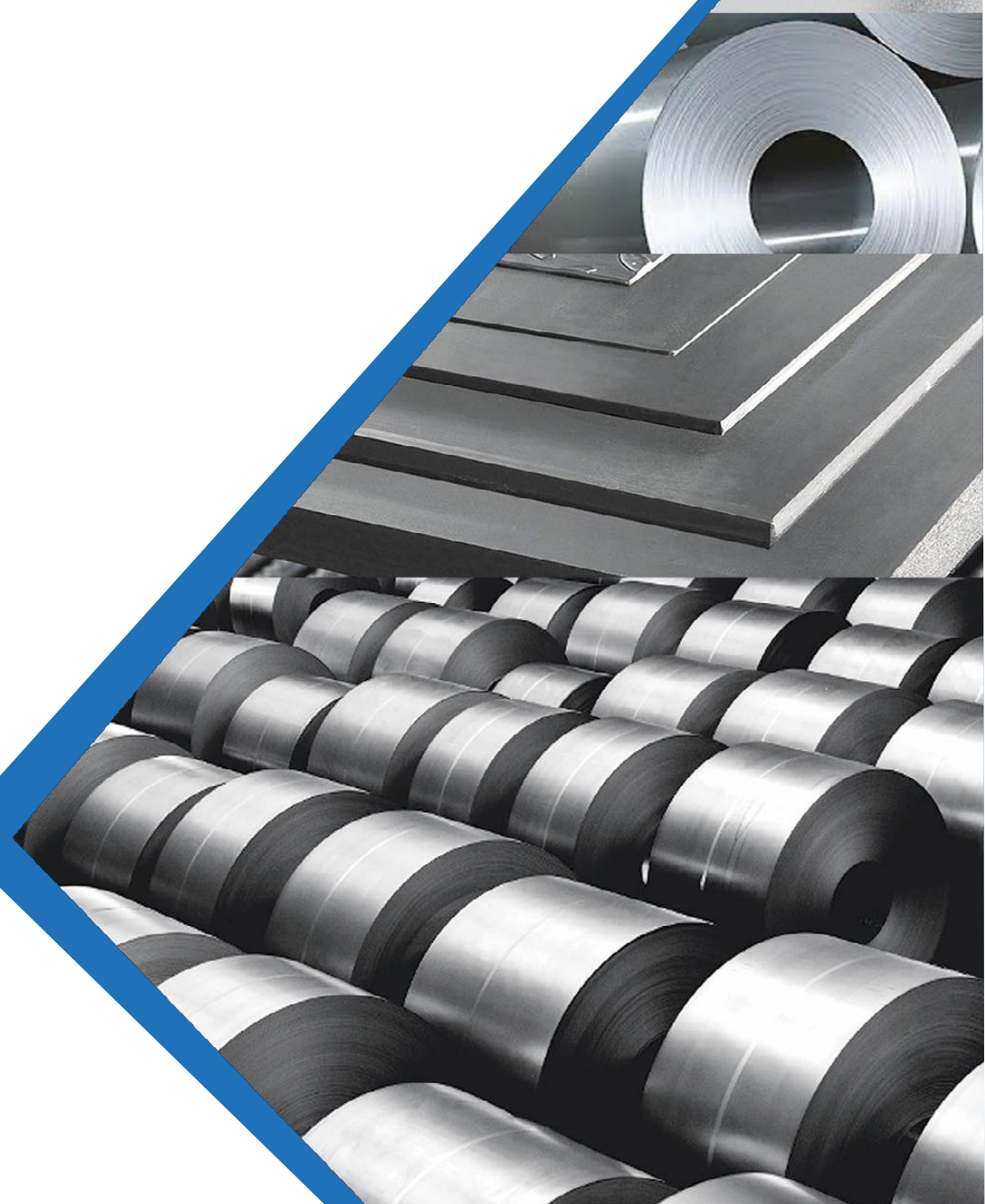

www.crtmetal.com www.crtimpex.com +90 326 502 63 63
info@crtmetal.com / info@crtimpex.com / sales@crtmetal.com / sales@crtimpex.com

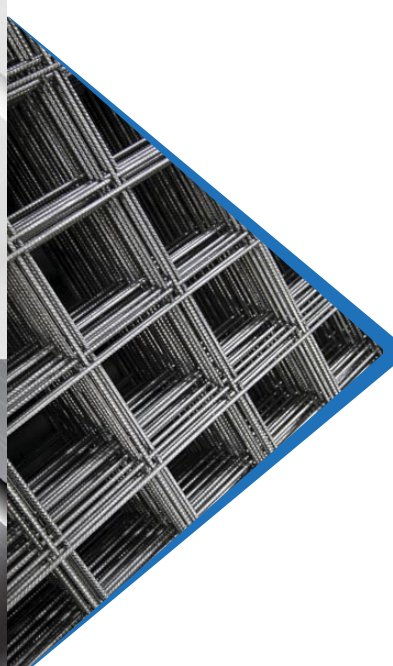



1985 yılından beri demir çelik sektöründe faaliyet göstermekte olan Ceritbinmez Group, aşağıdaki ürünlerin üretim/ ticaret ve sevkiyatını yapmaktadır;

- Sıcak haddelenmiş/ soğuk haddelenmiş/ galvanizli / boyalı sac ve levhalar, trapez
- Baklava dilimi / gözyaşı damlası / genişletilmiş / desenli levha saclar
- Profiller (köşebent/ lama / kare /yuvarlak / IPE/IPN/UPN/HEA/HEB)
- Borular (sanayi tipi ve iskele tipi), kutu profiller (kare ve dikdörtgen)
- Teller (galvanizli & siyah tavlı)
- Çelik hasır, soğuk çekim çubuklar ve inşaat demiri

Grup şirketlerimiz;
CRTIMPEX METAL A.Ş.
CRT METAL SAN. VE TİC. A.Ş.

Since 1985, Certibinmez Group which producing, trading and exporting variously steel products such as;

- HR/CR Steel Coils/Sheets, Galvanized/Painted Steel Coils/Sheets, Trapezoidal Sheets
- Checkered Plates /Tear Drop Patterns / Expanded Metals / Printed Metals
- Profiles (E.Angle, Flat Bars, Square Bars,IPE,IPN,UPN, HEA, HEB)
- Tubes, Rectangular And Hollow Sections
- Wires , (Galvanized & Black Anneled)
- Wire Mesh, Cold Rolled Bars And Rebars

Our Group Companies Are;
CRTIMPEX METAL A.S.
CRT METAL SAN. VE TİC. A.Ş.

Depuis 1985, Ceritbinmez group fabrique, commercialise et exporte de divers produits tels que :

- Tôles Plates et Bobines de Tôles laminées à froid et à chaud/ Tôles Plates et Bobines de tôles Galvanisées/teintées et Trapezoidales.
- Tôles en Aciers striés/ Tôles à motifs en forme de larme/ des tôles imprimées/ Métaux Déployés
- Profilés (Cornières, fers plats, fers Carrés, IPE, IPN, UPN-UPE)
- Tubes Carrés, rectangulaires et circulaires
- Fils de fer, (Galvanisés et Recuit noirs)
- Treillis soudés, fers à béton laminés à froids et à chaud.

Notre Groupe de Sociétés sont:
CRTIMPEX METAL A.S.
CRT METAL SAN. VE TİC. A.Ş.

**BAKLAVA DESENLİ
SAC**

**TÔLES
STRIEES**

**CHECKERED PLATE
(Diamond Pattern)**

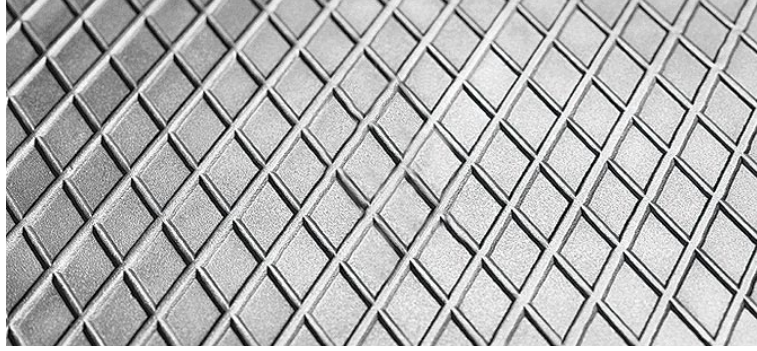

KALINLIK / THICKNESS / EPAISSEUR : (1,5/2,5mm – 15/16mm)
EN / WIDTH / LARGEUR : 1000mm/ 1250mm/ 1500mm
BOY / LENGTH / LONGUEUR : 2000mm/2500mm/3000mm/6000mm
KALİTE / QUALITY / QUALITE : DIN5922, ASTM A-786, BSN10051



**GÖZYAŞI DESENLİ
SAC**

**TÔLES A MOTIFS EN
FORME DE LARME**

**CHECKERED PLATE
(Tear Drop Pattern)**

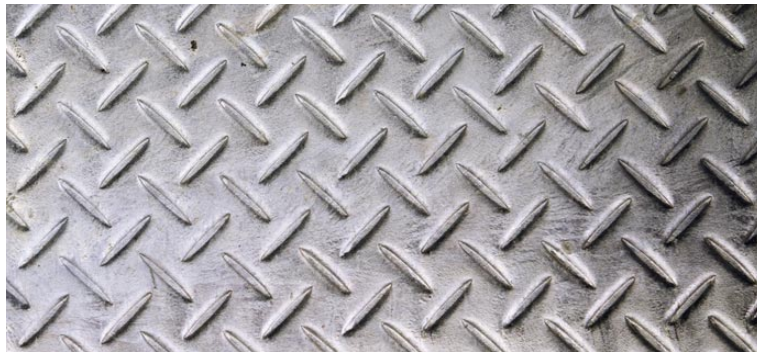

KALINLIK / THICKNESS / EPAISSEUR : 1,40mm – 16mm
EN / WIDTH / LARGEUR : 800mm-1550mm
BOY / LENGTH / LONGUEUR : 2000mm/2500mm/3000mm/6000mm
KALİTE / QUALITY / QUALITE : DIN5922, ASTM A-786, BSN10051

**SICAK HADDELENMİŞ
SİYAH SAC RULO**

**BOBINE DE TOLES NOIRES
LAMINEES A CHAUD**

**HOT ROLLED
BLACK COIL**



KALINLIK / THICKNESS / EPAISSEUR : 1,00mm – 25,00mm
EN / WIDTH / LARGEUR : 800mm-2000mm
RULO AĞIRLIK / COIL WEIGHT / POIDS DE LA BOBINE : MAX 30 TON
KALİTE / QUALITY / QUALITE : DIN5922, ASTM A-786, BSN10051



**SICAK HADDELENMİŞ
SİYAH SAC LEVHA**

**TOLES PLATES NOIRES
LAMINEES A CHAUD**

**HOT ROLLED
BLACK SHEET**

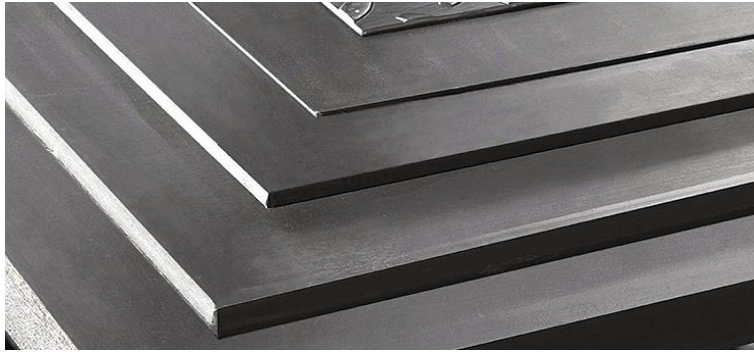

KALINLIK / THICKNESS / EPAISSEUR : 1,00mm – 80,00mm
EN / WIDTH / LARGEUR : 800mm-3200mm
BOY / LENGTH / LONGUEUR : 1000MM – 12000MM
PAKET AĞIRLIK / PACKAGE WEIGHT / POIDS DU PAQUET : MAX 10 TON
KALİTE / QUALITY / QUALITE : EN 10025 – 2, EN 10217-1,
API 5L, API 5CT

**GALVANİZLİ SOĞUK
HADDELENMİŞ SAC RULO**

**BOBINES DE TÔLES GALVANI-
SEES LAMINEES A FROID**

**GALVANIZED COLD
ROLLED COIL**



KALINLIK / THICKNESS / EPAISSEUR : 0,25mm – 3,00mm
EN / WIDTH / LARGEUR : 800mm-1530mm
RULO AĞIRLIK / COIL WEIGHT / POIDS DE LA BOBINE : MIN 5 TON - MAX 35 TON
KALİTE / QUALITY / QUALITE : DIN EN 10346



**GALVANİZLİ SOĞUK
HADDELENMİŞ SAC LEVHA**

**TÔLES PLATES GALVANI-
SEES LAMINEES A FROID**

**GALVANIZED COLD
ROLLED SHEET**

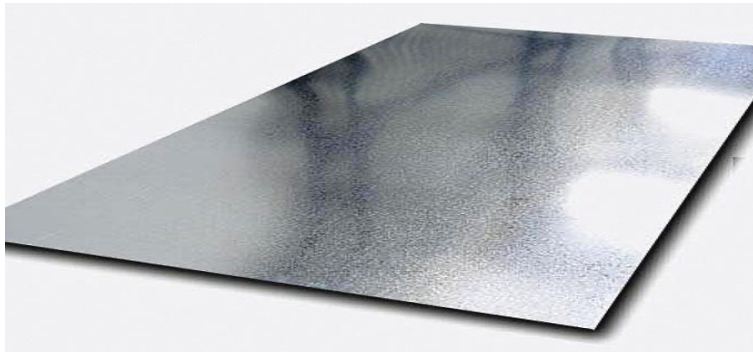

KALINLIK / THICKNESS / EPAISSEUR : 0,25mm – 3,00mm
EN / WIDTH / LARGEUR : 800mm-1530mm
BOY / LENGTH / LONGUEUR : 1000MM-6000MM
PAKET AĞIRLIK / PACKAGE WEIGHT / POIDS DU PAQUET : MAX 10 TON
KALİTE / QUALITY / QUALITE : DIN EN 10346

**SOĞUK HADDELENMİŞ
RULO**

**BOBINES DE TÔLES
LAMINEES A FROID**

**COLD ROLLED
COIL**



KALINLIK / THICKNESS / EPAISSEUR : 0,30mm – 3,00mm
EN / WIDTH / LARGEUR : 800mm-1530mm
RULO AĞIRLIK / COIL WEIGHT / POIDS DE LA BOBINE : MAX 30 TON
KALİTE / QUALITY / QUALITE : DC01-DC03-DC04-DC06-
DC01EK-DC04EK



**SOĞUK HADDELENMİŞ
LEVHA**

**TÔLES PLATES LAMINEES
A FROID**

**COLD ROLLED
SHEET**

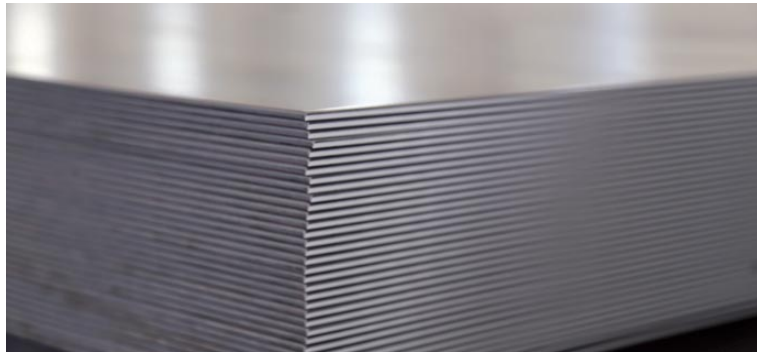

KALINLIK / THICKNESS / EPAISSEUR : 0,30mm – 3,00mm
EN / WIDTH / LARGEUR : 800mm-1530mm
BOY / LENGTH / LARGEUR : 1000MM-6000MM
PAKET AĞIRLIK / PACKAGE WEIGHT / POIDS DU PAQUET: MAX 10 TON
KALİTE / QUALITY/ QUALITE : DC01-DC03-DC04-DC06-DC01EK-DC04EK

**BOYALI
SAC RULO**

**BOBINES DE TÔLES TEINTEES
GALVANISEES**

**PREPAINTED
GALVANIZED COIL**



KALINLIK / THICKNESS / EPAISSEUR	: 0,25mm – 1,20mm
EN / WIDTH / LARGEUR	: 800mm-1550mm
ÇİNKO KAPLAMA / ZINC COATING / CHARGE DE ZINC	: 60-275 GR/M2
RULO AĞIRLIĞI / COIL WEIGHT / POIDS DE LA BOBINE	: MAX 10 TON
BOYA TİPLERİ / COLOR TYPE / TYPE DE COULEUR	: POLYESTER/PLYSTER –
PLASTISOL/PLASTISAOL- PVDF/POLYVINYLE- PURPA- POLYESTER WRINKLE POLIURETAN	
KALİTE / QUALITY / QUALITE	: DX51D+ Z - DX52D+Z - DX53D+Z DX54D+Z S220GD+Z - S250GD+Z - S280GD+Z -S320GD+Z -S350GD+Z



**BOYALI
SAC LEVHA**

**TÔLES PLATES PRE-
TEINTEES GALVANISEES**

**PREPAINTED GALVANIZED
SHEET**

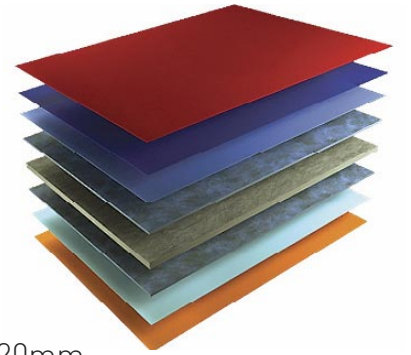

KALINLIK / THICKNESS / EPAISSEUR	: 0,25mm – 1,20mm
EN / WIDTH / LARGEUR	: 800mm-1550mm
UZUNLUK / LENGTH / LONGUEUR	: 800mm-1550mm
ÇİNKO KAPLAMA / ZINC COATING / CHARGE DE ZINC	: 60-275 GR/M2
PAKET AĞIRLIĞI / PACKAGE WEIGHT / POIDS DU PAQUET	: MAX 8 TON
BOYA TİPLERİ / COLOR TYPE / DE COULEUR	: POLYESTER/PLYSTER –
PLASTISOL/PLASTISAOL- PVDF/POLYVINYLE- PURPA- POLYESTER WRINKLE - POLIURETAN	
KALİTE / QUALITY / QUALITE	: DX51D+Z - DX52D+Z - DX53D+Z - DX54D+Z S220GD+Z - S250GD+Z - S280GD+Z - S320GD+Z - S350GD+Z

**DİLİNMIŞ
RULO**

**BOBINE
REFENDU**

**SLITTED
COILS**



KALINLIK / THICKNESS / EPAISSEUR	: 0,25mm – 3,00mm
EN / WIDTH / LARGEUR	: MIN 30 MM
ÇİNKO KAPLAMA / ZINC COATING / CHARGE DU ZINC	: 60 – 275 GR/M2
RULO AĞIRLIĞI / COIL WEIGHT / POIDS DE LA BOBINE	: MAX 10 TON
KALİTE / QUALITY / QUALITE	: DX51D+Z - DX52D+Z - DX53D+Z - DX54D+Z S220GD+Z - S250GD+Z - S280GD+Z - S320GD+Z -S350GD+Z



**TRAPEZ
SAC**

**TÔLES
TRAPEZOIDALES**

**TRAPEZOIDAL
SHEET**

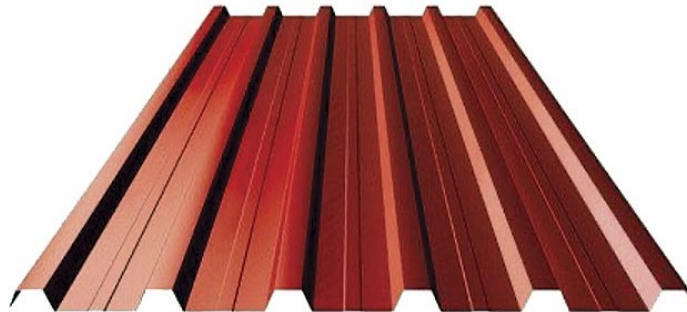

KALINLIK / THICKNESS / EPAISSEUR	: 0,30MM – 1,20MM
EN / WIDTH / LARGEUR	: 860/1000MM – 1050/1220MM
UZUNLUK / LENGTH / LONGUEUR	: 2000MM – 12000MM
PAKET AĞIRLIĞI / PACKAGE WEIGHT / POIDS DU PAQUET	: MAX 5 TON
FORM / FORME	: 27/200

**SANAYİ VE
İSKELE BORULARI**

**TUYAUX INSDUSTRIELS
ET ECHAFAUDAGE**

**INDUSTRIAL AND
SCAFFOLD PIPES**



DIŞ ÇAP / OUTER DIAMETER / DIAMETRE EXTERIEUR : Ø12mm – 114mm
KALINLIK / THICKNESS / EPAISSEUR : 2,00mm-6,00mm
UZUNLUK / LENGTH/ LONGUEUR : 6-12METERS
KALİTE / QUALITY/ QUALITE : DIN2394 – TS EN 10305-3 –
TS EN 10219-2

KULLANIM YERİ / USAGE AREA / DOMAINE D'UTILISATION : İNŞAAT VE TARIM SEKTÖRÜ /
BUILDING & AGRICULTURE USAGES / ILS SONT UTILISES DANS LES SECTEURS DE LA
TUYAUTERIE INDUSTRIELLES DE FABRICATION ET DE CONSTRUCTION.



**GENİŞLETİLMİŞ
SAC**

**TOLES
DEPLOYEES**

**EXPANDED
METAL**

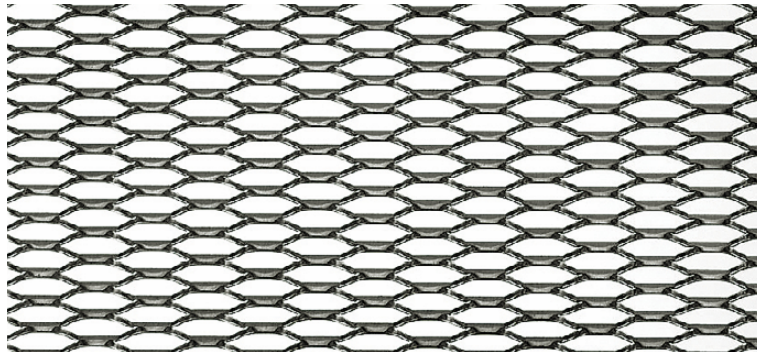

KALINLIK / THICKNESS / Diamètre / EPAISSEUR : 0,80mm – 6,00mm
EN / WIDTH / LARGEUR : 800mm-1550mm
UZUNLUK / LENGTH / LONGUEUR : 2000mm/2500mm/3000mm
KALİTE / QUALITY / QUALITE : DIN5922, ASTM A-786, BSN10051

**KARE
PROFİL**

**TUBES
CARRES**

**SQUARE PROFILE-
HOLLOW SECTION**



KALINLIK / THICKNESS / EPAISSEUR	: 0,70MM – 8,00MM
DIŞ KESİT / OUTER SECTION / SECTION EXTERIEURE	: 10x10MM – 175x175MM
UZUNLUK / LENGTH / LONGUEUR	: 4000MM – 12000MM
PAKET AĞIRLIĞI / PACKAGE WEIGHT / POIDS DEU PAQUET	: MAX 3 TON
KALİTE / QUALITY / QUALITE	: DIN2395, TS5317, TS EN 10219, TS EN 10305, (S235 JR/ S275 JR /S 355 JR ACC TO EN 10025)



**DİKDÖRTGEN
PROFİL**

**TUBES
RECTANGULAIRES**

**RECTANGULAR
PROFILE-HOLLOW SECTION**



KALINLIK / THICKNESS / EPAISSEUR	: 0,70MM – 8,00MM
DIŞ KESİT / OUTER SECTION / SECTION EXTERIEURE	: 20x10MM – 250x100MM
UZUNLUK / LENGTH / LONGUEUR	: 4000MM – 12000MM
PAKET AĞIRLIĞI / PACKAGE WEIGHT / POIDS DU PAQUET	: MAX 3 TON
KALİTE / QUALITY/ QUALITE	: DIN2395, TS5317, TS EN 10219, TS EN 10305, (S235 JR/ S275 JR /S 355 JR ACC TO EN 10025)

KARE DEMİR

FER CARRE

SQUARE BAR



ÖLÇÜ / SIZE / DIMENSION

: MIN 8x8MM –MAX 70x70MM

UZUNLUK / LENGTH / LONGUEUR

: 4000MM – 12000MM

PAKET AĞIRLIĞI / PACKAGE WEIGHT / POIDS DU PAQUET

: MAX 3 TON

KALİTE / QUALITY / QUALITE

: S235 JR/ S275 JR / S 355 JR

ACC TO EN 10025, ASTM A36 / ASTM A 529 GR 50 / ACC TO A6 , ST37-2, ST44-2, ST52-3



YUVARLAK DEMİR

FER ROUND

ROUND BAR



ÖLÇÜ / SIZE / DIMENSION

: MIN 5,00MM –MAX 30MM

UZUNLUK / LENGTH / LONGUEUR

: 4000MM – 12000MM

PAKET AĞIRLIĞI / PACKAGE WEIGHT / POIDS DU PAQUET

: MAX 3 TON

KALİTE / QUALITY / QUALITE

: S235 JR/ S275 JR / S 355 JR ACC TO EN
10025, ASTM A36 / ASTM A 529 GR 50
ACC TO A6 , ST37-2, ST44-2, ST52-3

IPN/IPE PROFİL

IPN/IPE PROFILES

IPN/IPE PROFILES



ÖLÇÜ / SIZE / DIMENSION
UZUNLUK / LENGTH / LONGUEUR
PAKET AĞIRLIĞI / PACKAGE WEIGHT / POIDS DU PAQUET
KALİTE / QUALITY / QUALITE

: MIN 80MM –MAX 300MM
: 4000MM – 12000MM
: MAX 3 TON
: S235 JR/ S275 JR /S 355 JR
ACC TO EN 10025, ASTMA A36 /
ASTM A 529 GR 50 / ACC TO A6,
ST37-2, ST44-2, ST52-3



UAC/UPN PROFİL

UAC/UPN PROFILES

UAC/UPN PROFILES

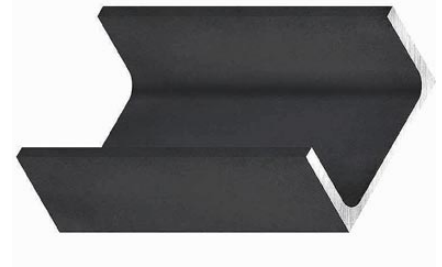

UAC ÖLÇÜ / UAC SIZE / DIMENSION UAC
UPN ÖLÇÜ / UPN SIZE DIMENSION UPN
UZUNLUK / LENGTH / LONGUEUR
PAKET AĞIRLIĞI / PACKAGE WEIGHT / POIDS DU PAQUET
KALİTE / QUALITY/ QUALITE

: MIN 40MM –MAX 65MM
: MIN 80MM –MAX 300MM
: 4000MM – 12000MM
: MAX 3 TON
: S235 JR/ S275 JR /S 355 JR
ACC TO EN 10025, ASTMA A36
ASTM A 529 GR 50 ACC TO A6,
ST37-2, ST44-2, ST52-3

HEA/ HEB PROFİL

HEA/ HEB PROFILES

HEA/ HEB PROFİL



ÖLÇÜ / SIZE / DIMENSION

: MIN 100MM –MAX 600MM

UZUNLUK / LENGTH / LONGUEUR

: 4000MM – 12000MM

PAKET AĞIRLIĞI / PACKAGE WEIGHT / POIDS DU PAQUET

: MAX 3 TON

KALİTE / QUALITY / QUALITE

: S235 JR/ S275 JR /S 355 JR ACC TO EN
10025, ASTMA A36 / ASTM A 529 GR 50
ACC TO A6 , ST37-2, ST44-2, ST52-3



T DEMİRİ

PROFILS ACIER T

T BARS

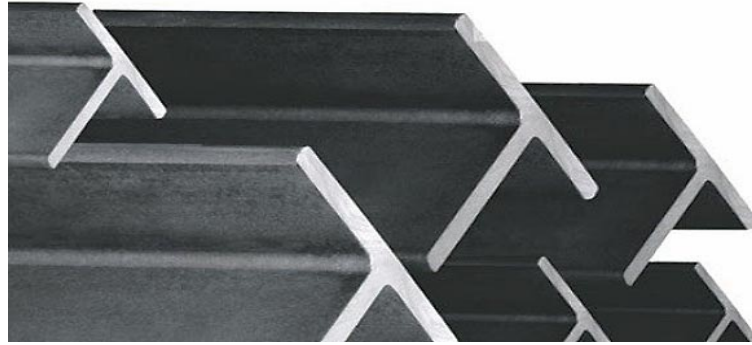

ÖLÇÜ / SIZE / DIMENSION

: MIN 20x20x2,70MM –MAX
50x50x6,00MM

UZUNLUK / LENGTH / LONGUEUR

: 4000MM – 12000MM

PAKET AĞIRLIĞI / PACKAGE WEIGHT / POIDS DU PAQUET

: MAX 3 TON

KALİTE / QUALITY/ QUALITE

: S235 JR/ S275 JR /S 355 JR
ACC TO EN 10025, ASTMA A36
ASTM A 529 GR 50 ACC TO A6,
ST37-2, ST44-2, ST52-3

İNŞAAT DEMİRİ

FER A BETON

REINFORCING BAR

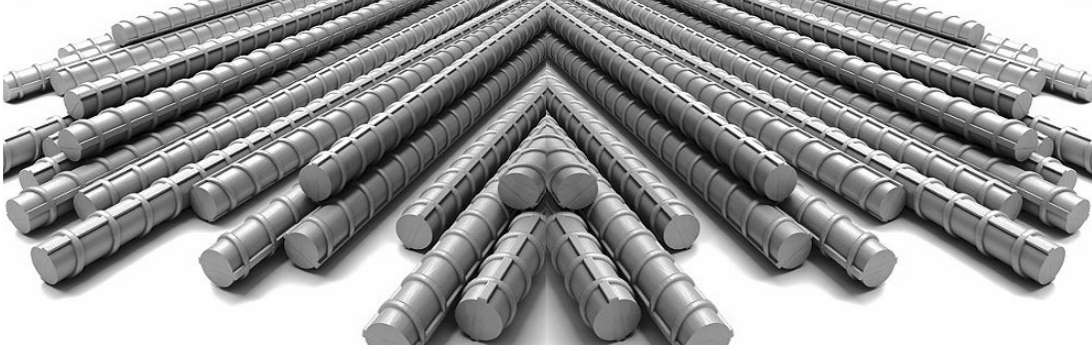

ÖLÇÜ / SIZE / DIAMETRE

: MIN 8MM –MAX 32MM

UZUNLUK / LENGTH/ LONGUEUR

: 4000MM – 12000MM

PAKET AĞIRLIĞI / PACKAGE WEIGHT / POIDS DU PAQUET : MAX 3 TON

KALİTE / QUALITY/ QUALITE

: AMERICAN /CANADIAN/ EURONORM

/BRITISH / GERMAN/ ISRAELI / MAROC/ PORTUGUESE / IRAQ / ETHIOPIAN / JAPANESE /

KOREAN STANDARTS / NORMES AMERICAINES / CANADA / NORME EUROPEENNE/ ANGLAIS

/ ALLEMAND / ISRAEL / MAROC / PORTUGAL / IRAK / ÉTHIOPIE / JAPON / CORÉE



FİLMAŞİN

FIL MACHINE

WIRE ROD



ÖLÇÜ / SIZE / DIAMETRE

: MIN 5,5MM –MAX 16 MM

PAKET AĞIRLIĞI / PACKAGE WEIGHT / POIDS DU PAQUET

: MAX 5 TON

KALİTE / QUALITY/ QUALITE

: DIN17100, EN10025, ST37-2,
SAE1012, SAE1010, SAE1008,
SAE1006, BS449 GR250

ÇELİK HASIR

TREILLIS SOUDE

WIRE MESH

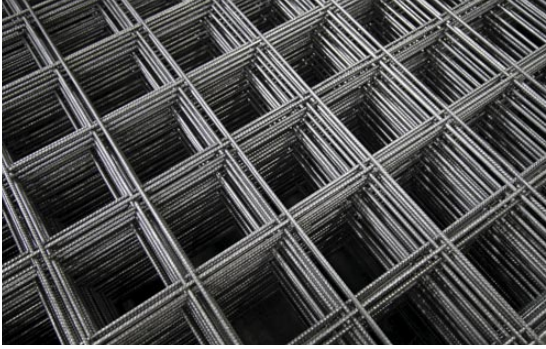

PAKET AĞIRLIĞI / PACKAGE WEIGHT /
POIDS DU PAQUET: MAX 5 TON

NO.	Hasır Tipi Mesh Type Type de Treillis Soudé	NO.	Hasır Tipi Mesh Type Type de Treillis Soudé	NO.	Hasır Tipi Mesh Type Type de Treillis Soudé	NO.	Hasır Tipi Mesh Type Type de Treillis Soudé	NO.	Hasır Tipi Mesh Type Type de Treillis Soudé
1	R106	12	Q106/106	23	Q257/131	34	Q317/131	45	Q335/424
2	R131	13	Q131/131	24	Q257/158	35	Q317/158	46	Q377/131
3	R158	14	Q158/131	25	Q257/188	36	Q317/188	47	Q377/158
4	R188	15	Q158/158	26	Q257/221	37	Q317/221	48	Q377/188
5	R221	16	Q188/131	27	Q257/257	38	Q317/257	49	Q377/221
6	R257	17	Q188/158	28	Q295/131	39	Q317/295	50	Q377/257
7	R295	18	Q188/188	29	Q295/158	40	Q335/221	51	Q377/295
8	R317	19	Q221/131	30	Q295/188	41	Q335/257	52	Q443/158
9	R335	20	Q221/158	31	Q295/221	42	Q335/295	53	Q443/188
10	R377	21	Q221/188	32	Q295/257	43	Q335/335	54	Q443/221
11	R443	22	Q221/221	33	Q295/295	44	Q335/378	55	Q443/257
								56	Q443/295



SOĞUK ÇEKİM
ÇUBUK

FER A BETON
LAMINE A FROID

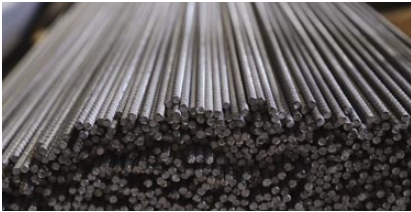

COLD ROLLED
DEFORMED BARS



ÖLÇÜ / SIZE / DIAMETRE
UZUNLUK / LENGTH / LONGUEUR

: MIN 5,00MM –MAX 8,00MM
: 4000MM – 12000MM OR IN COILS
MAX 3 TON

PAKET AĞIRLIĞI / PACKAGE WEIGHT / POIDS DU PAQUET
KALİTE / QUALITY / QUALITE

: MAX 3 TON
: SAE1006/1008/1010 EN 10025

GALVANİZLİ TEL

FIL DE FER GALVANISE

GALVANIZED WIRE



ÖLÇÜ / SIZE / DIMENSION

: MIN 1,50MM –MAX 8,00MM

ÇİNKO KAPLAMA / ZINC COATING / CHARGE DU ZINC : MIN40 GR/M2 – MAX 360 GR/M2

ÇEKME MUKAVEMETİ / TENSILE STRENGTH /

RESISTANCE A LA RUPTURE

: MIN400N/MM2 – MAX1000N/MM2

PAKETLEME / PACKAGING / PAQUET

: IN ROSETTE COILS BETWEEN 50-1000 KG

KALİTE / QUALITY / QUALITE

: SAE1006, SAE 1008, SAE1010, SAE 1022



**TAVLI
TEL**

**FIL DE FER
NOIR RECUIT**

**BLACK
ANNEALED WIRE**



ÖLÇÜ / SIZE / DIMENSION

: MIN 1,00MM –MAX 6,00MM

ÇEKME MUKAVEMETİ / TENSILE STRENGTH /

RESISTANCE A LA RUPTURE

: MIN 300N/MM2 – MAX 450N/MM2

PAKETLEME / PACKAGING / PAQUET

: IN COILS BETWEEN 10-500 KG

KALİTE / QUALITY / QUALITE

: SAE1006, SAE 1008, SAE1010, SAE 1022

KALİTE SERTİFİKALARIMIZ



QUALITY CERTIFICATES





- İskenderun Ofis
İskenderun Head Office
Mustafa Kemal Mah. İbrahim
Karaođlanođlu Cd. No:58
Atay İş Merkezi K:7 D:44-45
Hatay/İskenderun
Tel : +90 326 502 6363 – 60- 67
- Payas Fabrika
Payas Factory
Yıldırım Beyazıt Mah. Özgöl
Çolak Cd. No:146/1
Payas/Hatay
Tel : +90 538 889 0263

www.crtmetal.com
info@crtmetal.com
sales@crtmetal.com



- İskenderun Ofis
İskenderun Head Office
Mustafa Kemal Mah. İbrahim
Karaođlanođlu Cd. No:58
Atay İş Merkezi K:7 D:46
Hatay/İskenderun
Tel : +90 326 502 6363 – 60- 67
- Osmaniye Fabrika
Osmaniye Factory
Büyüktüysüz Mah. Vali Kerem Al Cd. No:3
Organize Sanayi Bölgesi Toprakkale/Osmaniye
Tel : +90 328 802 0050-51
Fax : +90 328 802 0052

www.crtimpex.com
info@crtimpex.com
sales@crtimpex.com

